

V3.0

3DMAKERPRO

store.3dmakerpro.com

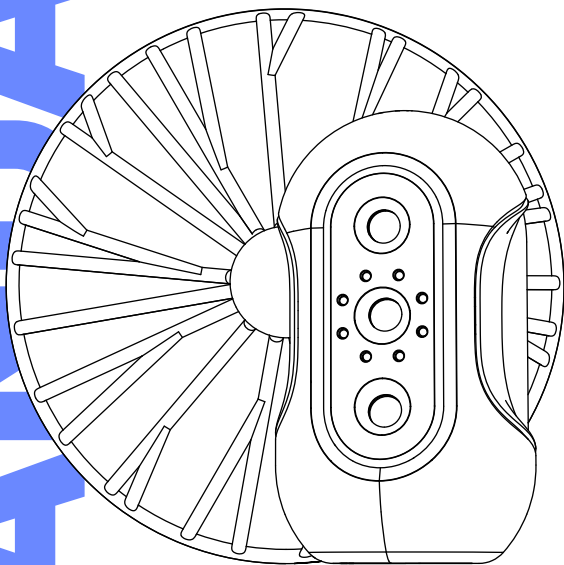

MOLE

Hardware Connection **P1**

Packing List **P3**

3DMAKERPRO

- f @3DMakerProCares
- @official3DMakerPro
- @3DMakerPro
- https://store.3dmakerpro.com/
- service@3dmakerpro.com

JimuMeta

- f @JimuMeta
- @JimuMeta
- https://www.jimumeta.com/
- service@jimumeta.com

Check the **Tutorial** below to know how Mole works.
<https://youtu.be/EpBBW7k2zMU>

Download latest **JMStudio** from
<https://forum.jimumeta.com/home/help/download.html>

Get latest **Manual** from
<https://forum.jimumeta.com/home/help/manual.html>



P1

HARDWARE CONNECTION

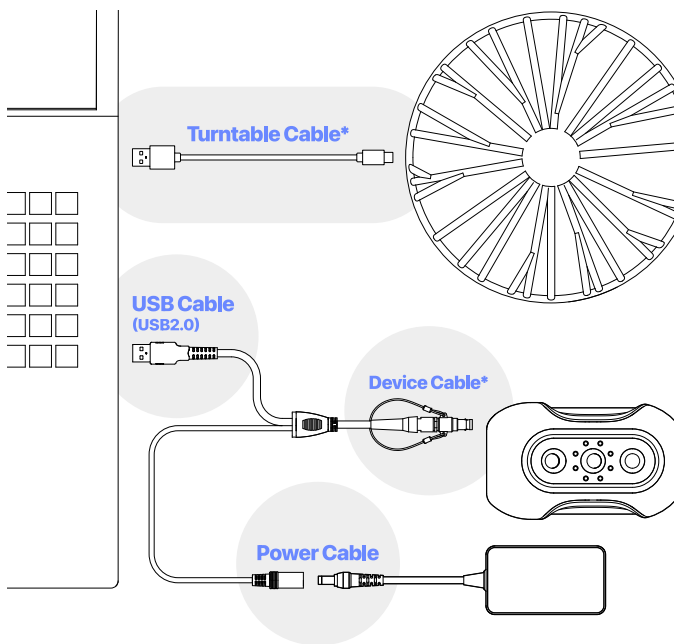

Plug one side of the data transmission cable (as it's showing Device Cable) into the scanner, another into the computer USB2.0 port and power adapter.

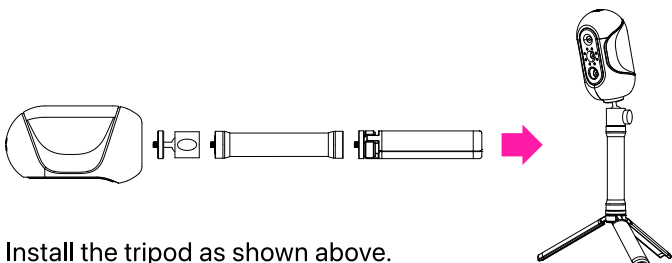

Install the tripod as shown above.

* Device Cable

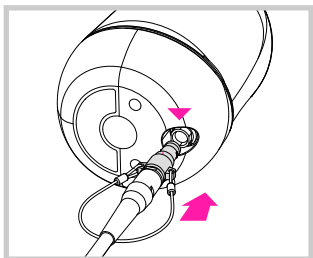

Plug the device cable into the port of the scanner, make sure the red dot is lined up with the groove on the port.

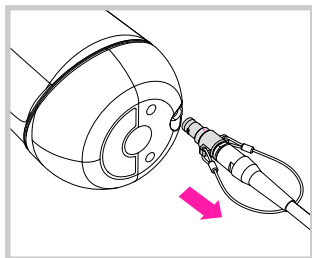

The small cable on the plug can assist you to pull it out.

* Turntable Cable

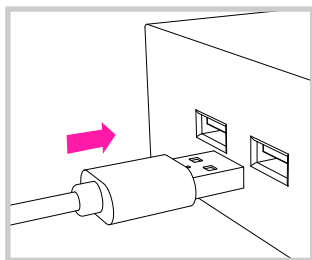
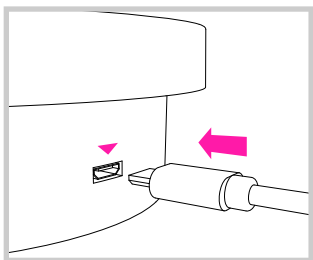

The turntable can be powered up by connecting it to the computer or the power adapter with the turntable cable.

P3

PACKING LIST

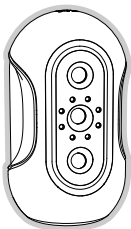

Scanner Body

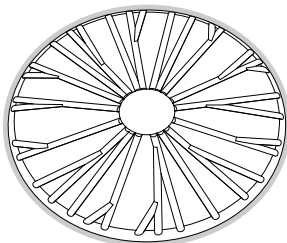

Turntable Top¹

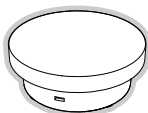

Turntable²

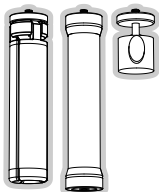

Tripod⁴

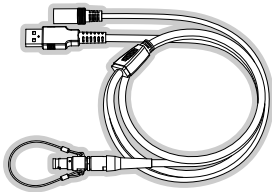

Device Cable



Turntable Cable³

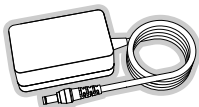

Power Adapter

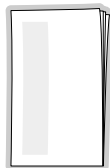

Manual

* Product images are for illustrative purposes only.

* ¹²³⁴Not included in the Standard Combo.

Operating System Requirement



Minimum

Intel Core i5 8th, 16GB RAM, MX250 GPU with 2GB VRAM

Recommended

Intel Core i7 8th, 16GB RAM, NVIDIA1060 GPU with 4GB VRAM



To prevent antivirus software from blocking the driver, please uninstall the antivirus software.