

### Setting Up Wi-Fi

You can easily operate your **SOL** from your computer. You can upload prints directly, and track print status. To set up your Wi-Fi connection:

1. Go to **Network**. The **Wi-Fi** tab is selected by default.
2. Press the **Choose a Network** button, select a network and key in the password.  
The IP address appears on screen.
3. Make a note of the printer **IP Address**.
4. Select your Wi-Fi network.

---

### Updating Firmware

Ackuretta is always adding new resins and improving functionality. If you are connected to the Internet, check for the latest firmware:

1. Go to **Settings**
2. Select **Update**
3. Press **Update firmware online**

---

### Print

You can print either over Wi-Fi or from your USB device.

1. Go to **Print**
2. Select **USB** or **Computer**, depending on your location of your file
3. Choose your IBF file
4. Change your material setting, if necessary
5. Press **Print**

---

### ■ Documentation and Support

For the full set of **SOL** documentation, go to:  
<https://ackuretta.com/sol/>



For community feedback, see our Ackuretta's User Group on Facebook:  
<https://www.facebook.com/groups/2164055477166718/>

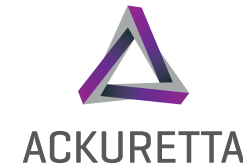

# SOL

## Quick Start Guide



[www.ackuretta.com](http://www.ackuretta.com)

## Package Contents



Vat (x2)



Build Platform



SOL 3D Printer



Ethernet Cable



Wi-Fi Dongle



Power Cable



Print Screen (+1)



Hex Key

## Product Specifications

3D Print Technology	Monochrome LCD Panel
Machine Size	271.3 mm (W) x 292 mm (L) x 416.8 mm (H)
Weight	15 kg approx.
Print Size	128 x 80 x 140 mm
XY Resolution	49 $\mu$ m
Slice Thickness	30 - 150 $\mu$ m
Resin Wavelength	385 - 405 nm
Power Supply	110 - 240V AC, 50-60Hz

## Setup Guide

### Software

Download and install the Alpha 3D software from the Ackuretta website:

<https://ackuretta.com/sol/>



### Unboxing

1. Remove the cables, hex key, two boxes, and packaging from the top and put them in a safe place.
2. Lift your printer out by the handles.
3. Secure your printer by the base to remove it from its internal packaging.

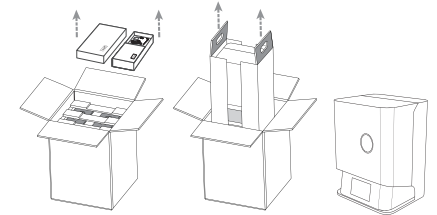

### Side Boxes

There are four small boxes in the package with the following contents:

**VAT:** 2x vats (one vat in place on the printer and another with the accessories)

**CABLE and TOOLS:** 1x ethernet cable, 1x power cable and 1x hex key (Allen wrench)

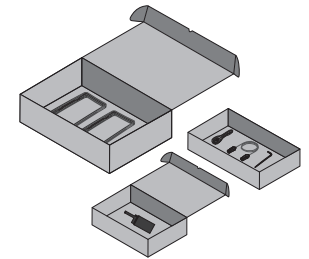

### Environment

Operate your **SOL** in a temperature-controlled room, between 18° - 25° C (64° - 77° F).

Ackuretta also recommends using UV-filtered LED lights in your workspace for both printing and cleaning.

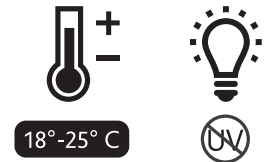

### Warning

Do not allow any resin or residue to come into contact with the hood on your printer because 3D printing resins have a corrosive effect on acrylic.